

**Addendum to the Fact Sheet for the
State of Washington Draft 2016 Construction Stormwater General
Permit**

Dated July 1, 2015

**Permit #WARXXXXXX for the Tesoro Savage Vancouver Energy
Distribution Terminal**

**Prepared by Washington Department of Ecology Water Quality
Program for the**

Energy Facility Site Evaluation Council (EFSEC)

October 31, 2016

Purpose of this Fact Sheet Addendum

This Fact Sheet Addendum (Addendum) is intended to accompany and supplement Ecology's July 1, 2015 Draft Construction Stormwater General Permit Fact Sheet (CSWGP Fact Sheet). The CSWGP Fact Sheet and this Addendum together (hereinafter "Vancouver Energy CSWGP Fact Sheet") address the Energy Facility Site Evaluation Council's (EFSEC) preparation of the draft National Pollutant Discharge Elimination System (NPDES) Construction Stormwater General Permit (CSWGP) for the proposed Tesoro Savage Vancouver Energy Distribution Terminal Project (Vancouver Energy Distribution Terminal).

The Vancouver Energy CSWGP Fact Sheet complies with Washington Administrative Code (WAC) 463-76-034, which requires EFSEC to prepare a draft permit and fact sheet for public evaluation before issuing an NPDES permit. Copies of the draft CSWGP, the Letter of Coverage and the Vancouver Energy CSWGP Fact Sheet will be available for public review and comment for thirty (30) days. Public comment is from **October 31, 2016 to November 29, 2016** (inclusive). After the public comment period closes, EFSEC will summarize the substantive comments and provide response to them. EFSEC will provide the summary and responses to comments in an Appendix to the Vancouver Energy CSWGP Fact Sheet. For more details on preparing and filing comments about these documents, please see **Part VIII-Public Involvement**.

Summary

Tesoro Savage Petroleum Terminal LLC (Vancouver Energy) submitted an Application for Site Certification (ASC) to EFSEC on August 29, 2013 to construct and operate a 360,000 barrel per day crude-by-rail trans loading oil terminal at the Port of Vancouver, WA. Part 5 of the ASC included an application for construction and industrial stormwater permits. On October 6, 2016 EFSEC received an updated/revised ASC.

Contents

I. General Information:	3
II. Facility Description	3
III. Tentative Determination	4
IV. NPDES Permit Development	4
V. Receiving Water	5
VI. EFSEC Determination for Permit Issuance	5
VII. Permit Modifications	6
VIII. Public Involvement	6

I. General Information:

This Addendum supplements the CSWGP Fact Sheet, and is prepared to provide information specific to the Vancouver Energy Distribution Terminal permit coverage, in compliance with WAC 463-76-034. The Special and General Permit Conditions described in the CSWGP Fact Sheet may be modified by this Addendum, the Coverage Letter for Permit #WARXXXXXX, or Administrative Order Docket #XXXX, or any subsequent Administrative Order issued by EFSEC.

II. Facility Description

This CSWGP coverage is issued for an Energy Distribution Terminal.

The Site address is: 5501 NW Old Lower River Road, Vancouver, WA 98660.

The type of discharge proposed is construction stormwater and dewatering water. The nature of construction stormwater discharges are intermittent. The rate and frequency of construction stormwater discharges are based on a rainfall-runoff erosivity, soil erodibility, slope length, slope steepness, topography, cover-type, and support practice. The rate and frequency of dewatering discharges are based on volume of groundwater present within the subsurface excavation. Stormwater discharges can be highly intermittent, they are usually characterized by very high flows occurring over relatively short time intervals. (See CSWGP Fact Sheet p. 18 “Rationale for Non-Numeric Technology-Based Effluent Limits in This Permit”).

Table 1. General Facility Information

Facility Information	
Applicant	Tesoro Savage Petroleum Terminal LLC
Facility Name and Address	Vancouver Energy Terminal 3103 Lower River Road Vancouver, WA 98660
Designated Agent	Kelly Flint Executive VP – Group Leader – General Counsel Savage Companies 901 West Legacy Center Way Midvale, UT 84047 801-944-6600
Facility Location	Latitude: 45.651778°N Longitude: 122.731131°W
Discharge Waterbody Names and Locations	Columbia River Latitude: 45.6375°N Longitude: 122.7125°W Columbia River Latitude: 45.649722°N Longitude: 122.745833°W

Figure 1. Facility Location Map

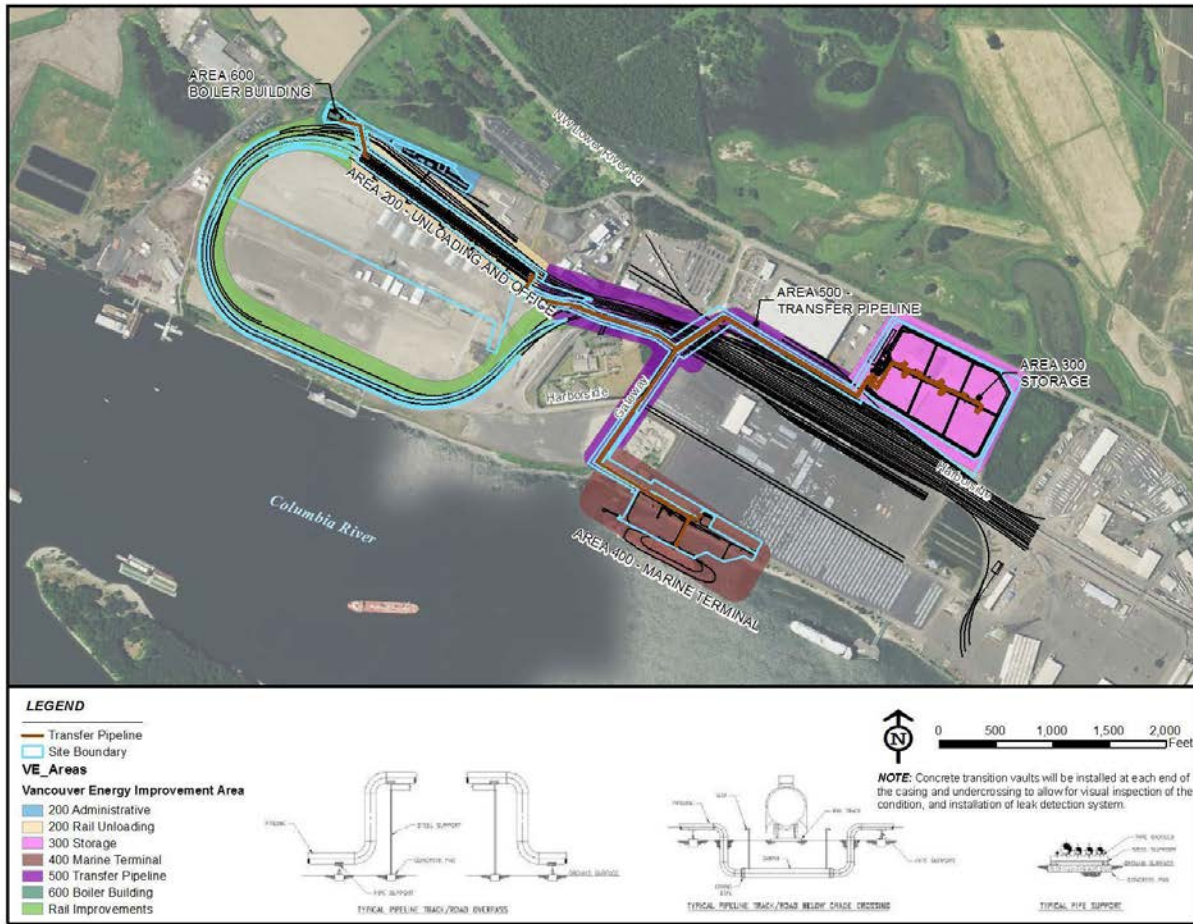

This figure is from the Vancouver Energy Terminal Application for Site Certification, May, 2016 Revision.

III. Tentative Determination

The council has proposed to issue coverage under the CSWGP for the Vancouver Energy Distribution Terminal.

IV. NPDES Permit Development

EFSEC has authority under Revised Code of Washington (RCW) 80.50, RCW 90.48.262, WAC 463-76-005, and WAC 463-76-025 to issue coverage under the CSWGP.

There are no numeric technology based effluent limitations included in the permit. (See CSWGP Fact Sheet p. 15-19 “Proposed Permit Limits”). For this permit, most of the technology-based limits are based on “best professional judgement” (BPJ) (CSWGP Fact Sheet P. 16). However,

the permit also includes the EPA effluent limitations guidelines effective February 1, 2010 and updated in 2014.

There are no numeric effluent standards proposed under this permit. However, there are non-numeric technology-based effluent limits that consist of Best Management Practices (BMPs) and All Known, Available, and Reasonable Methods of Prevention, Control, and Treatment (AKART). In addition, the permit adopted a list of prohibited discharges per 40 C.F.R. §450.21 which helps to ensure compliance with the state AKART requirements in Chapter 90.48 RCW. (See CSWGP Fact Sheet p. 18 “Rationale for Non-Numeric Technology-Based Effluent Limits in This Permit”).

Condition S3 prohibits discharges that cause or contribute to violations of Surface Water Quality Standards (WAC 173-201A), Ground Water Quality Standards (WAC 173-200), Sediment Management Standards (WAC 173-204), and human health-based criteria in the National Toxics Rule (40 C.F.R. 131.36). (See CSWGP Fact Sheet p. 13 “Compliance with Standards”).

The Permittee must handle and dispose of solid and liquid wastes generated by construction activity in accordance with permit Special Condition S3, Compliance with Standards; WAC 1073-216-110; and other applicable regulations such as requirements by local jurisdictions. The handling and disposal of solid or liquid wastes must not result in a violation of applicable water quality regulations (40 C.F.R. 122.44(k)(2), 40 C.F.R. 125.3(g), RCW 90.48.080, and WAC 173-216-110(1)(f)). (See CSWGP Fact Sheet p. 38 “S7. Solid and Liquid Waste Disposal”).

V. Receiving Water

The receiving water for this project is the Columbia River. The Aquatic Life Use for this section of the Columbia River is salmonid spawning, rearing, and migration. The Recreation Use is Primary Contact Recreation. Other uses are as a water supply (domestic, industrial, agricultural, stock) and miscellaneous uses (wildlife habitat, harvesting, commerce/navigation, boating, and aesthetics).

VI. EFSEC Determination for Permit Issuance

The procedures used by EFSEC in formulating its final determinations for the permit coverage and issuing permit coverage will be consistent with the requirements of RCW 80.50 and WAC 463-76. Where EFSEC procedures differ from those in the CSWGP Fact Sheet, EFSEC’s procedures apply.

EFSEC has made a tentative determination to issue coverage under the CSWGP, #WARXXXX, as modified by the Coverage Letter, for the Vancouver Energy Distribution Terminal, subject to appropriate changes or adjustments as may result from public comments, the public hearing record, or the U.S. Environmental Protection Agency (EPA) review.

VII. Permit Modifications

After CSWGP coverage is issued, modifications to the permit may be made in accordance with WAC 463-76-062. Cause for modifying the permit may include modifications necessary to impose numerical limits, if necessary, to comply with water quality standards for surface waters, with sediment quality standards, or with water quality standards for groundwater, after obtaining new information from sources such as inspections, effluent monitoring, outfall studies, and effluent mixing studies.

EFSEC may also modify this permit to comply with new or amended state or federal regulations.

VIII. Public Involvement

The Council tentatively plans to issue a permit to the applicant listed on page 1 of this Addendum. The permit contains conditions and effluent limitations, which are described in the Vancouver Energy CSWGP Fact Sheet and the Coverage Letter.

The Council published a Public Notice of Draft (PNOD) on October 31, 2016 in the Columbian newspaper to inform the public that a draft permit and fact sheet are available for review. Interested parties were mailed the notice on October 31, 2016 and are invited to submit written comments regarding the draft permit. The draft permit and fact sheet are available for viewing at the EFSEC website: <http://www.efsec.wa.gov> The draft permit, fact sheet, and related documents are also available for inspection and copying between the hours of 8:00 a.m. and 5:00 p.m. weekdays, by appointment, at EFSEC's office listed below,. Written comments should be mailed to:

Sonia Bumpus
Energy Facility Site Evaluation Council
PO Box 43172
Olympia, Washington 98504-3172

Any interested party may comment on the draft permit within the 30-day comment period to the address above. The Council will hold a hearing on November 29, 2016 beginning at 2:00 pm at:

Clark College, Gaiser Hall
1933 Fort Vancouver Way
Vancouver, Washington

Comments should reference specific text in the permit followed by proposed modifications or concerns when possible. Comments may address technical issues, accuracy, and completeness of information, the scope of the facility's proposed coverage, adequacy of environmental protection, permit conditions, or any other concern that would result from issuance of this permit.

The Council will consider all comments received by midnight on November 29, 2016 in formulating a final determination to issue, revise, or deny the permit. The Council's response to all significant comments will be available upon request.

Further information may be obtained from the Council by telephone at (360) 664-1160, or at the EFSEC web site at www.efsec.wa.gov.